

Park Boženy Němcové(1:700) - Klad listů (1:4462)



Park Boženy Němcové(1:700), 1/28



Park Boženy Němcové(1:700), 2/28



Park Boženy Němcové(1:700), 3/28



Park Boženy Němcové(1:700), 4/28



Park Boženy Němcové(1:700), 7/28

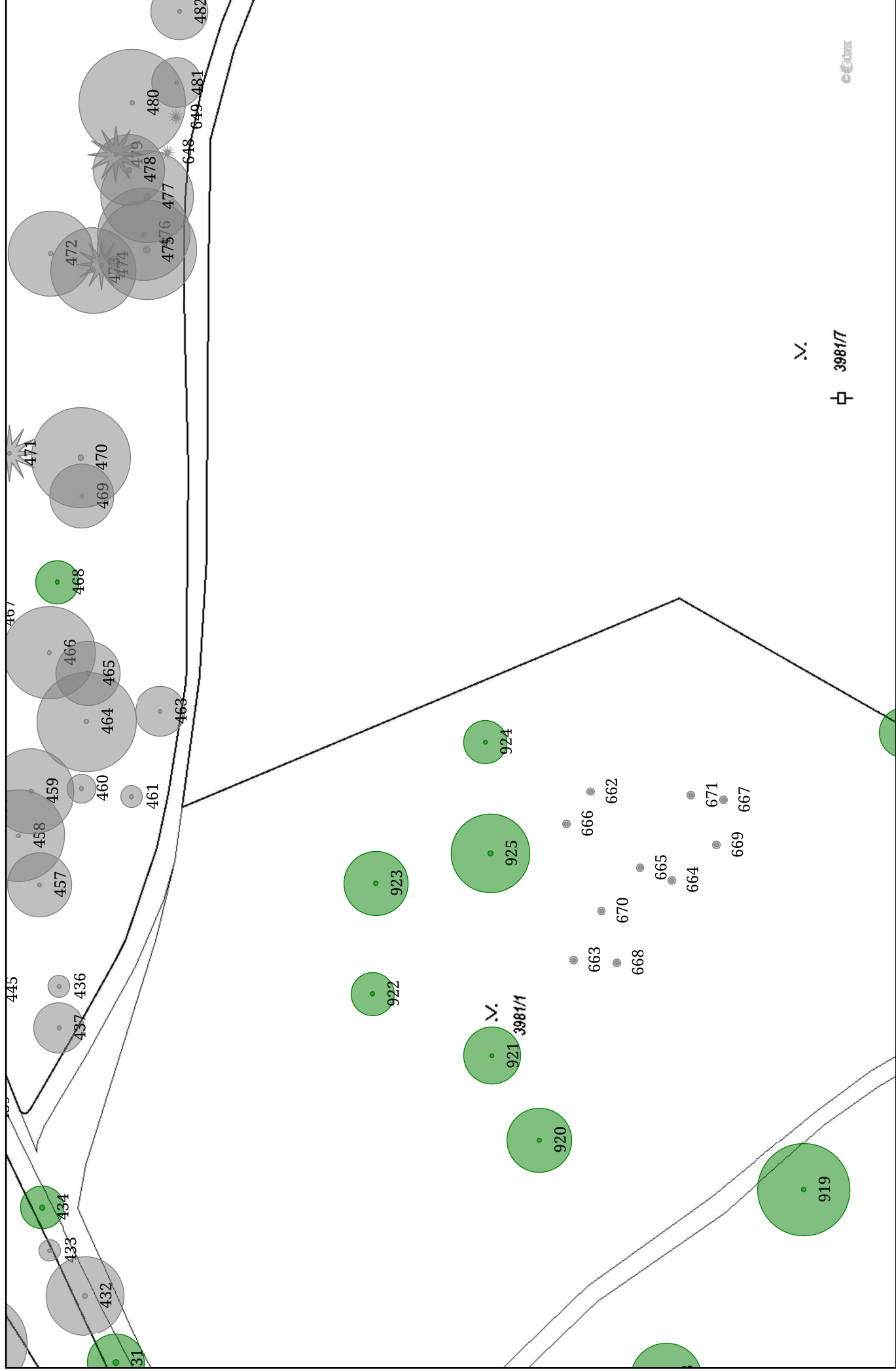

Park Boženy Němcové(1:700), 8/28

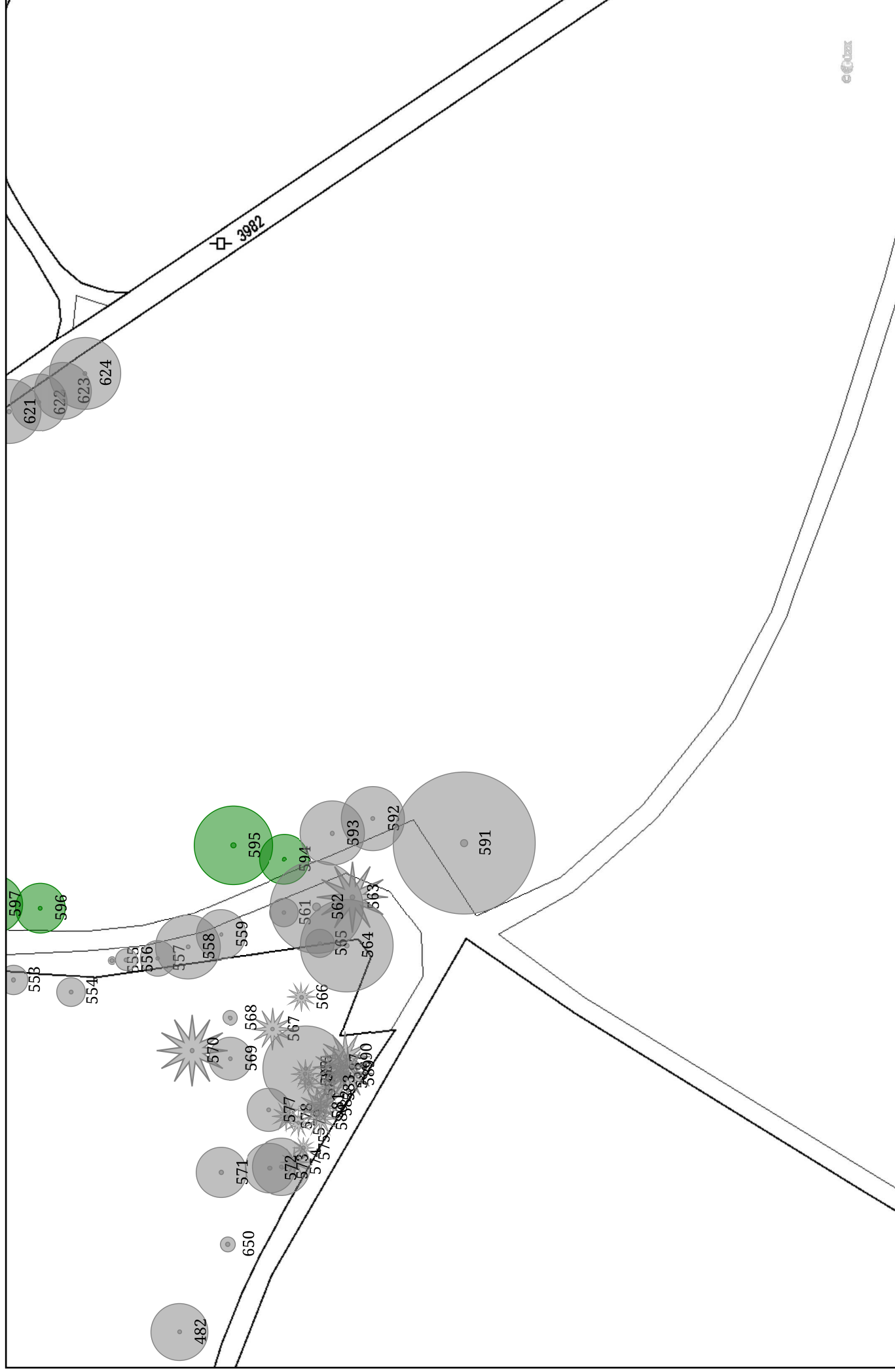

Park Boženy Němcové(1:700), 9/28

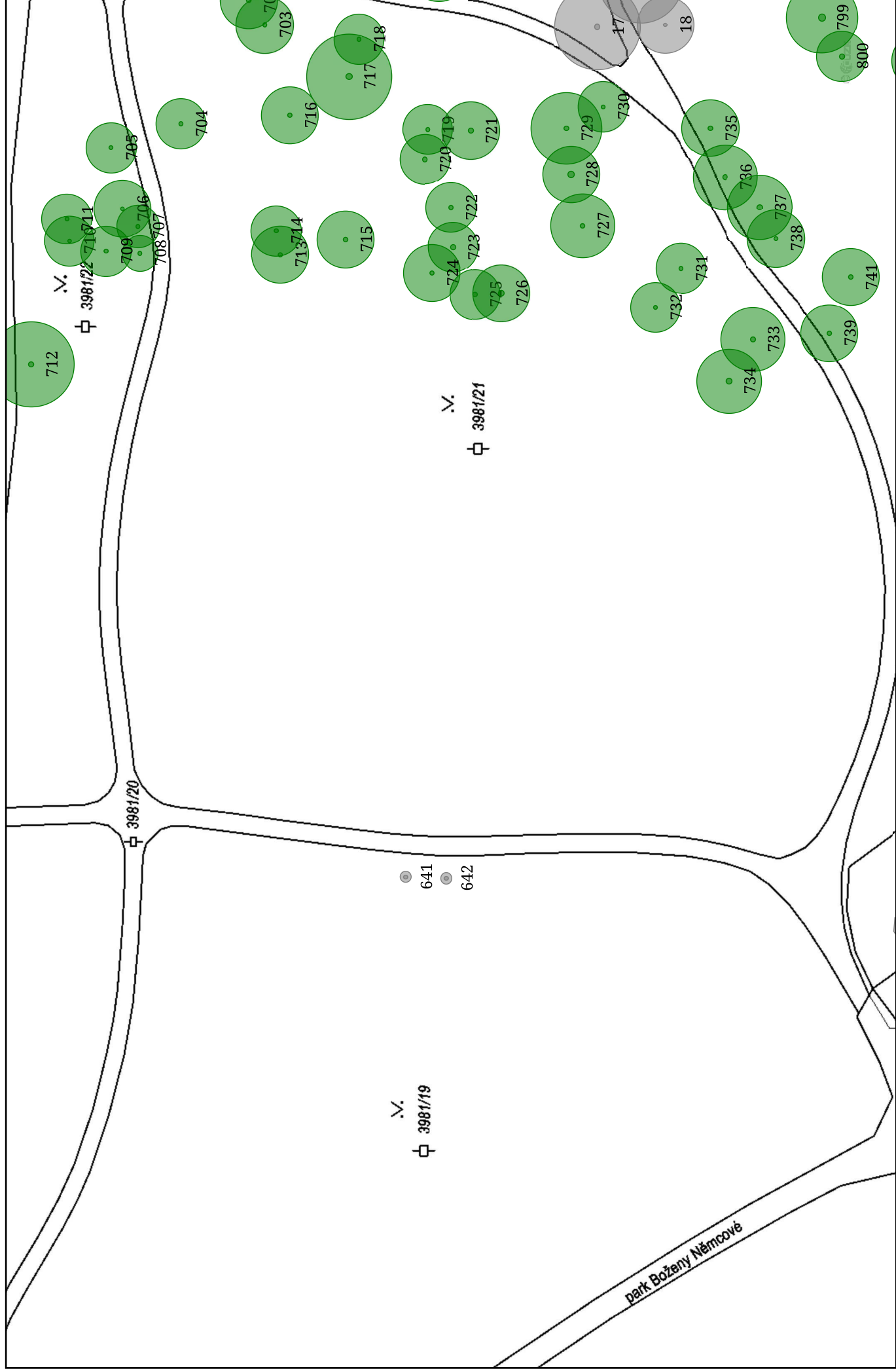

Park Boženy Němcové(1:700), 11/28

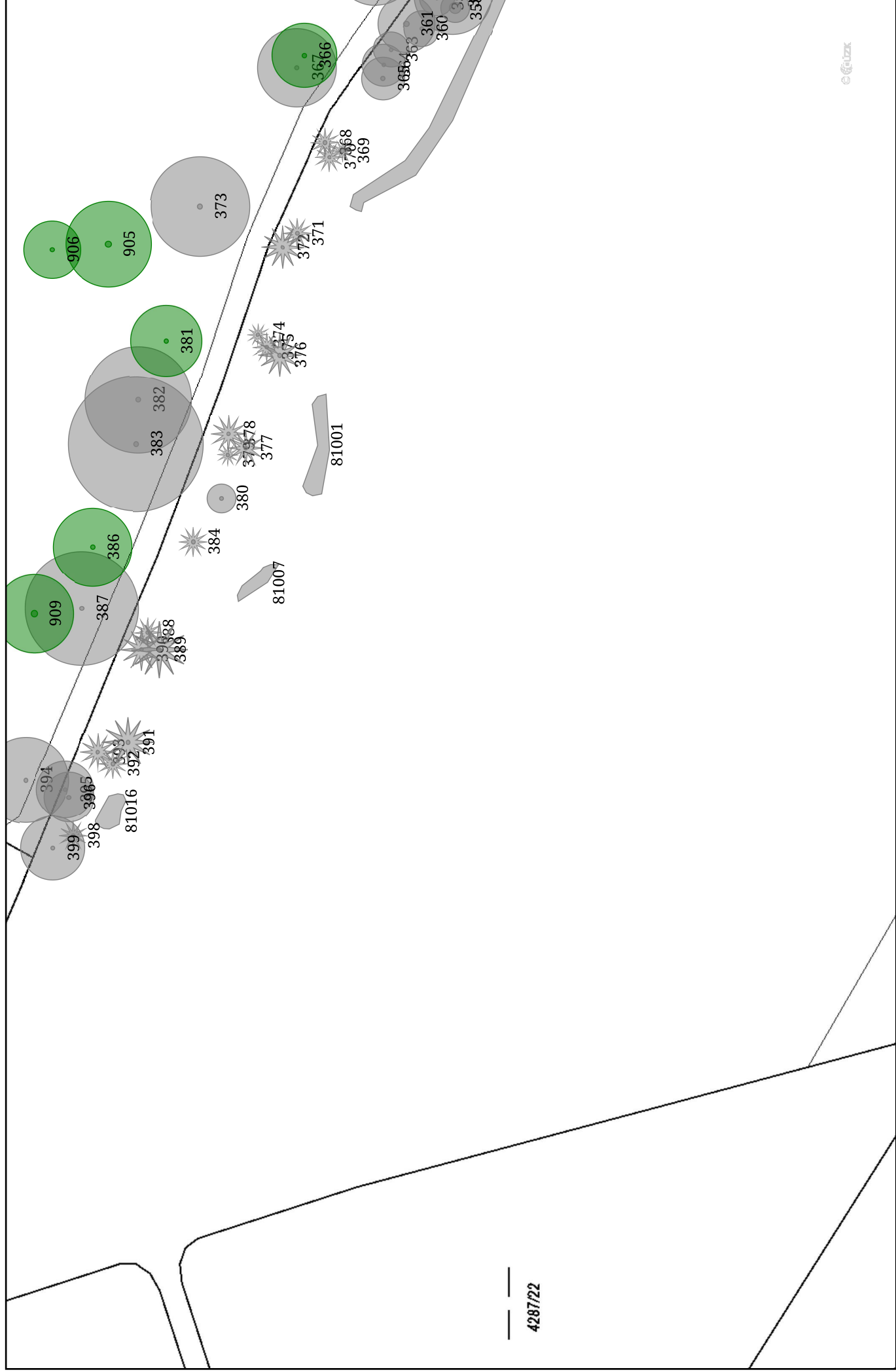

Park Boženy Němcové(1:700), 12/28

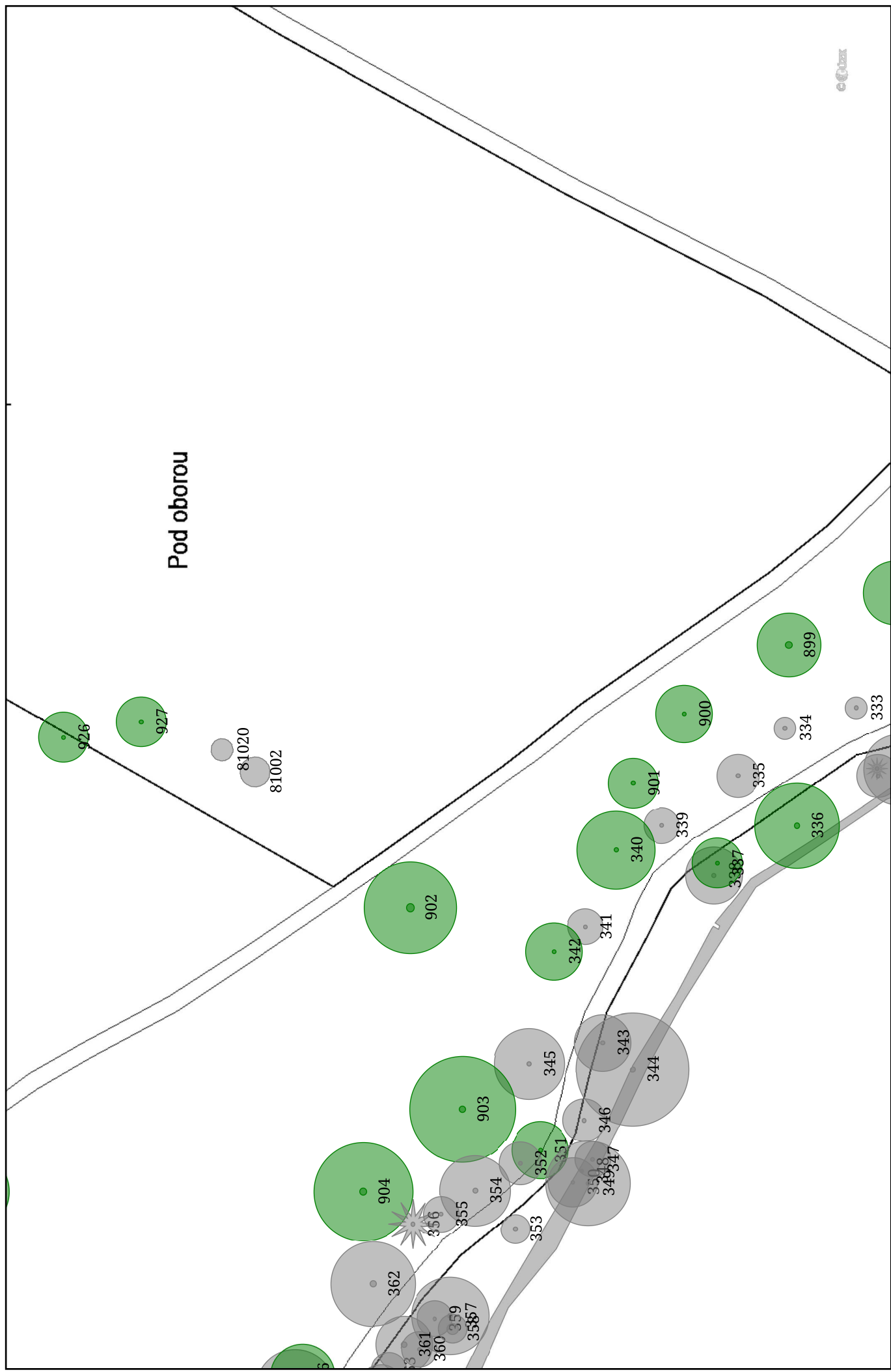

Park Boženy Němcové(1:700), 13/28



Park Boženy Němcové(1:700), 14/28

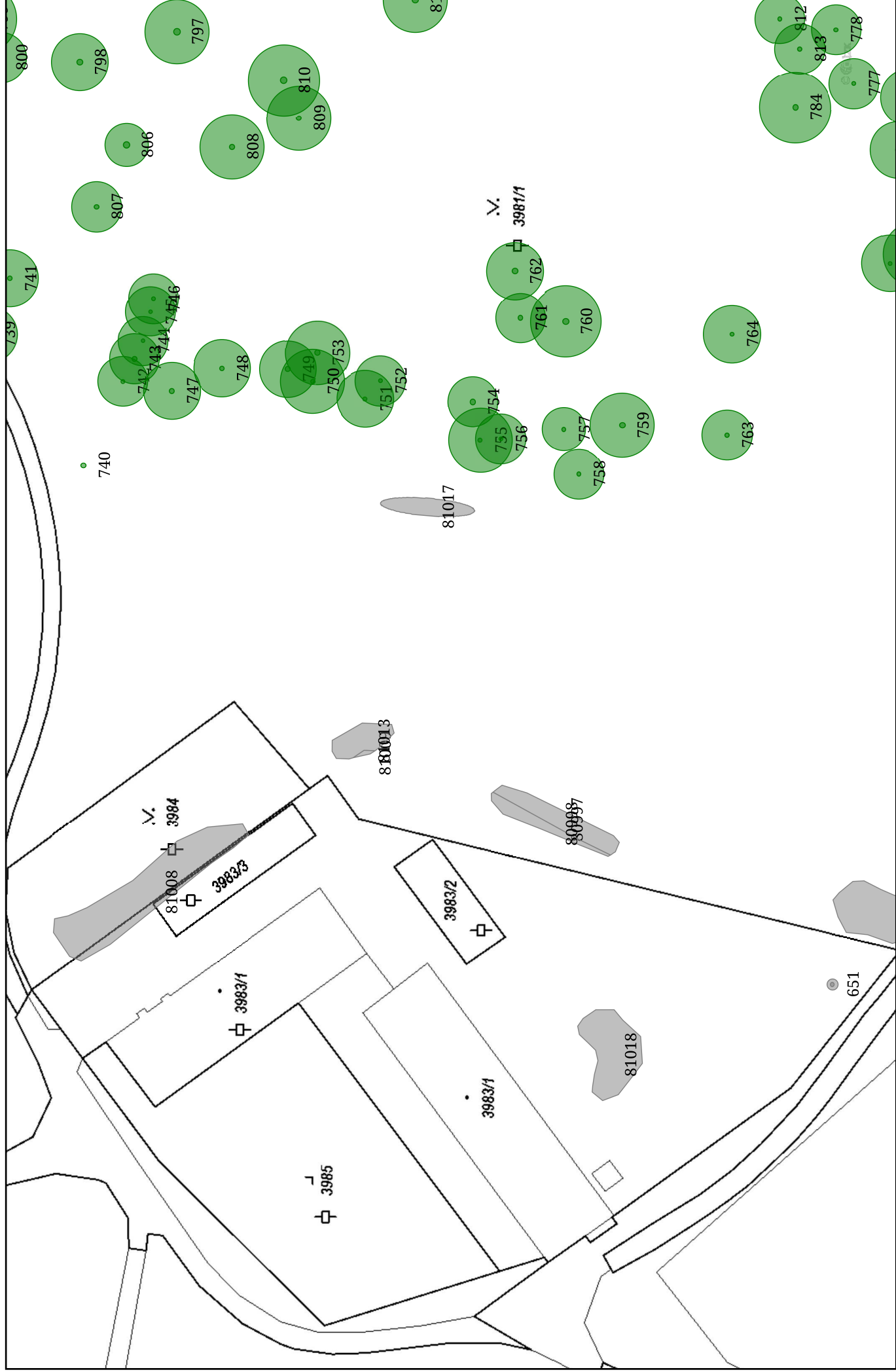

Park Boženy Němcové(1:700), 16/28



Park Boženy Němcové(1:700), 17/28

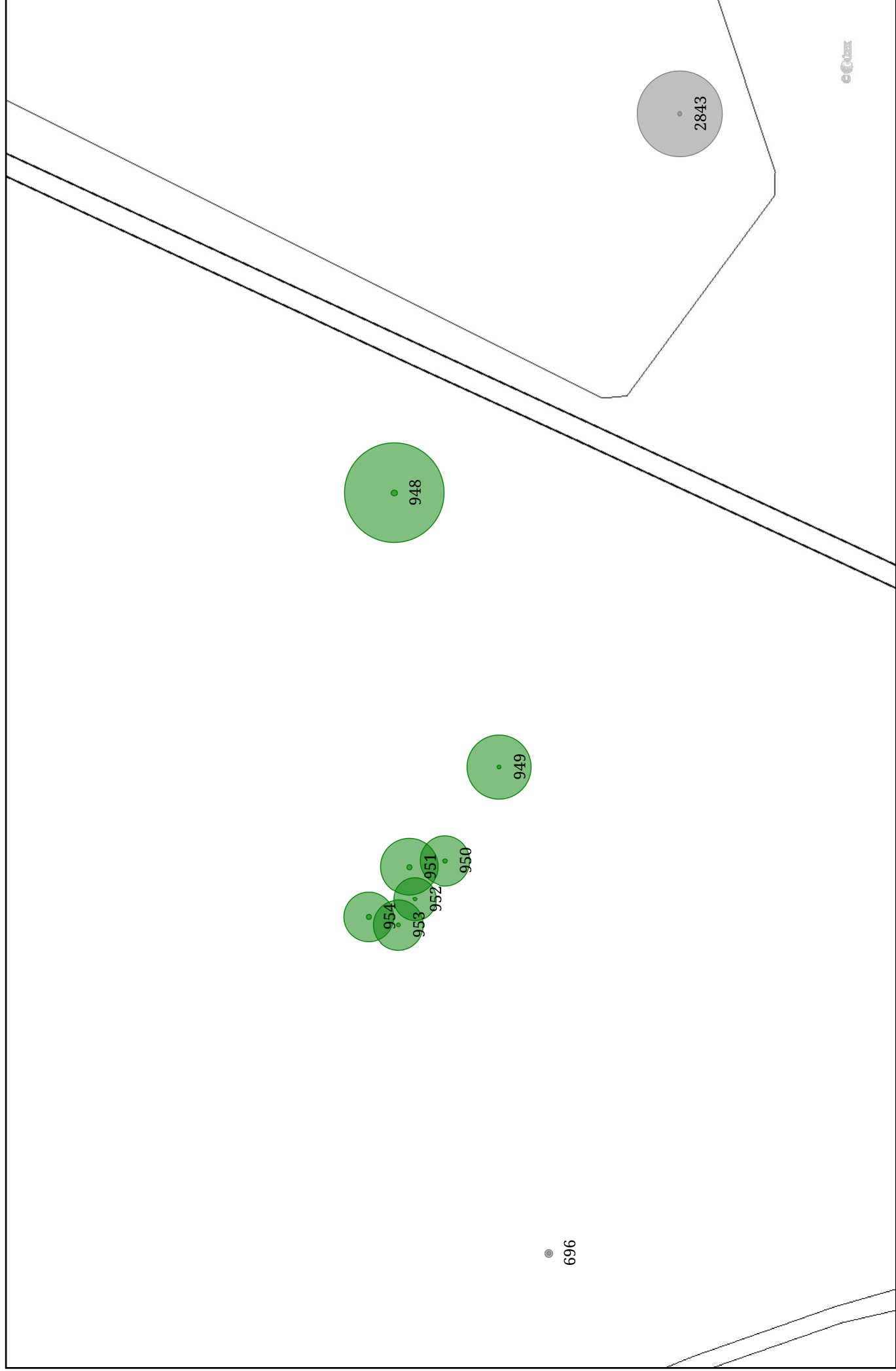

Park Boženy Němcové(1:700), 18/28



Park Boženy Němcové(1:700), 19/28

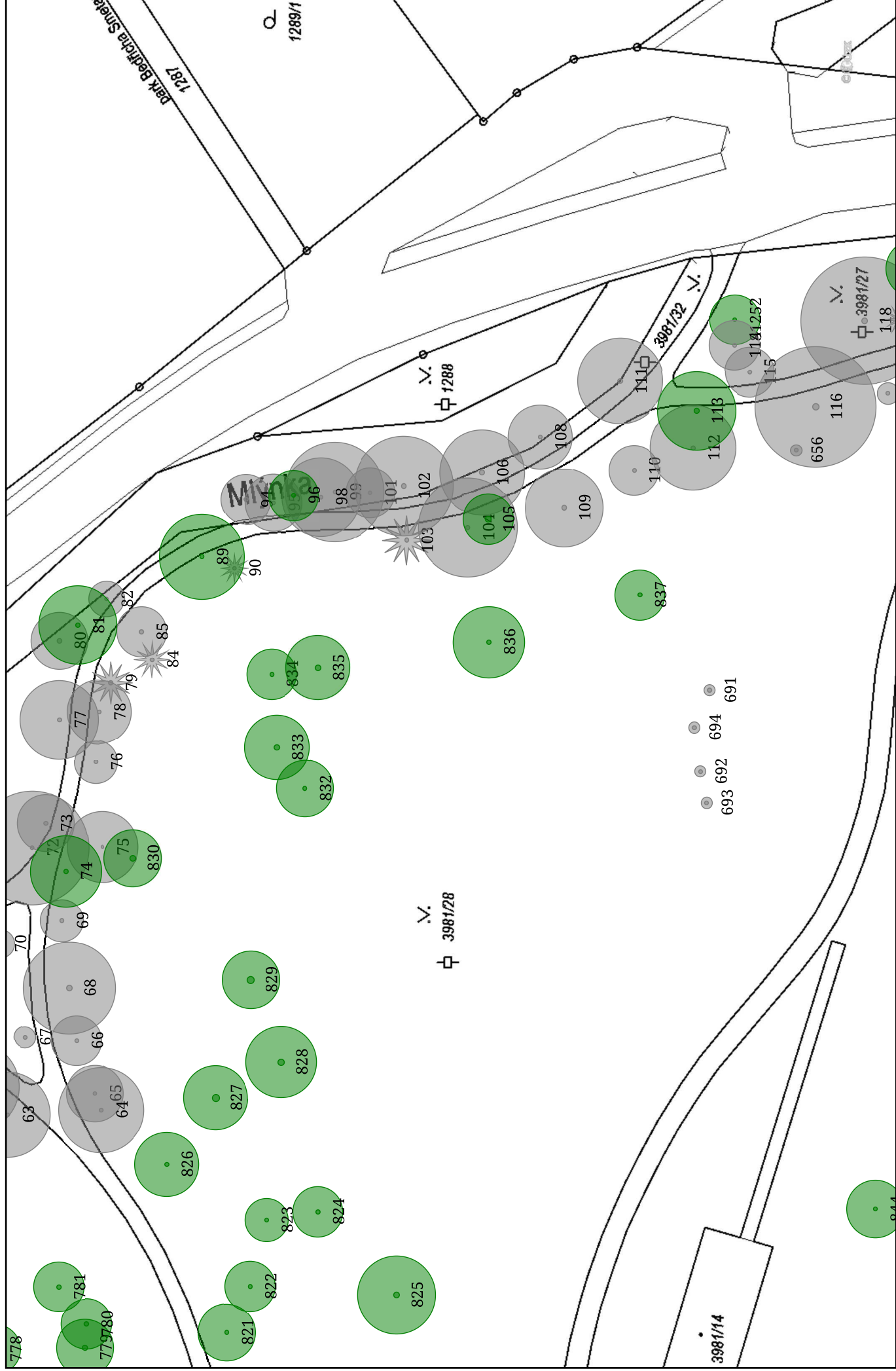

4287/25

4287/24

3971/1

2069/5

e

Park Boženy Němcové(1:700), 22/28

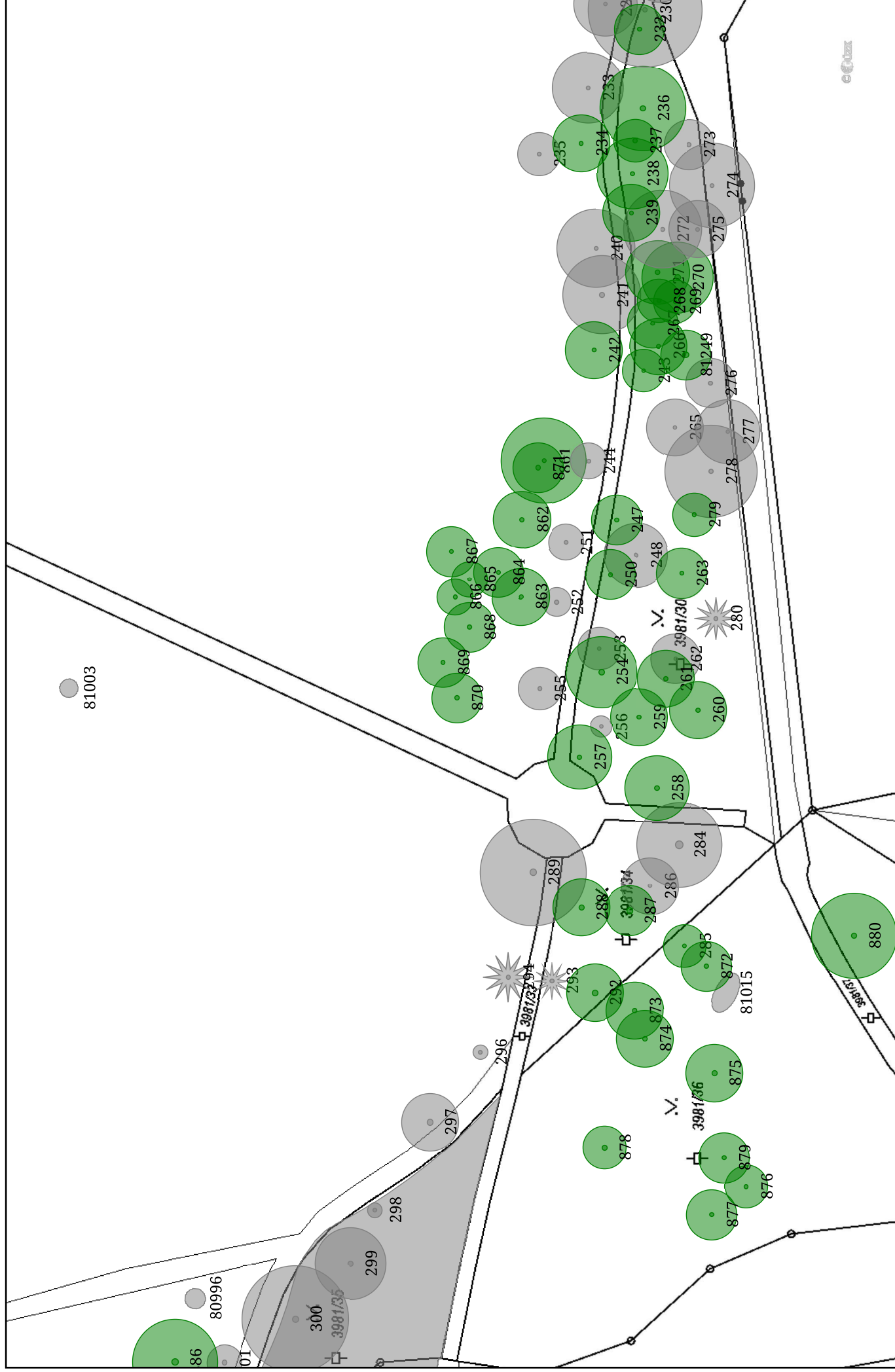

Park Boženy Němcové(1:700), 23/28

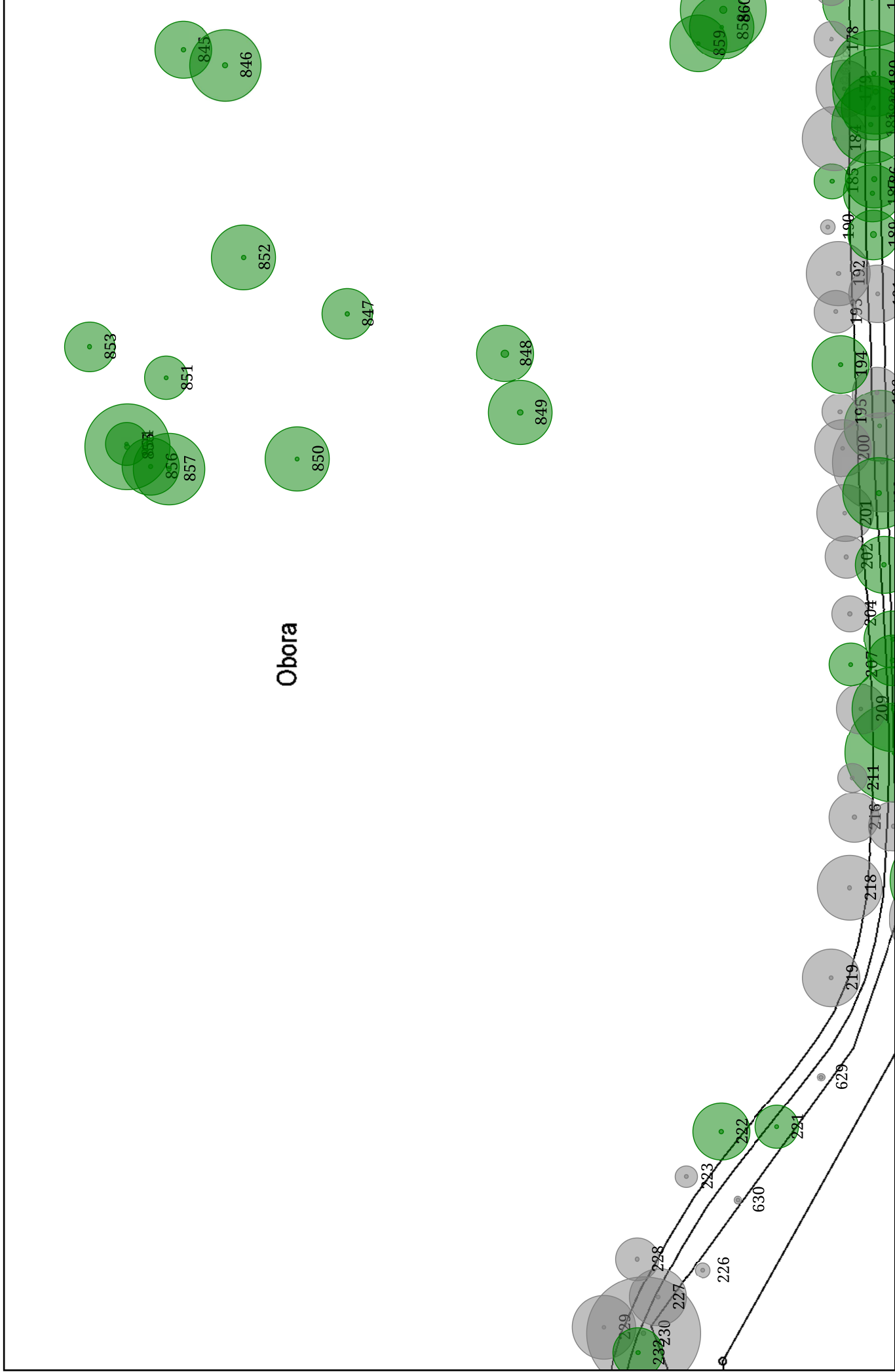

The map depicts a park area with a central building labeled "3981/29". A street named "Karola Śliwki" runs along the top. Numerous circular markers, some green and some grey, are scattered throughout the area, many with numbers. A scale bar is located in the bottom right corner.

Key features and labels include:

- Street: Karola Śliwki
- Central Building: 3981/29
- Other Building: 92/1
- Other Building: 92/2
- Other Building: 92/3
- Other Building: 92/4
- Other Building: 92/5
- Other Building: 92/6
- Other Building: 92/7
- Other Building: 92/8
- Other Building: 92/9
- Other Building: 92/10
- Other Building: 92/11
- Other Building: 92/12
- Other Building: 92/13
- Other Building: 92/14
- Other Building: 92/15
- Other Building: 92/16
- Other Building: 92/17
- Other Building: 92/18
- Other Building: 92/19
- Other Building: 92/20
- Other Building: 92/21
- Other Building: 92/22
- Other Building: 92/23
- Other Building: 92/24
- Other Building: 92/25
- Other Building: 92/26
- Other Building: 92/27
- Other Building: 92/28
- Other Building: 92/29
- Other Building: 92/30
- Other Building: 92/31
- Other Building: 92/32
- Other Building: 92/33
- Other Building: 92/34
- Other Building: 92/35
- Other Building: 92/36
- Other Building: 92/37
- Other Building: 92/38
- Other Building: 92/39
- Other Building: 92/40
- Other Building: 92/41
- Other Building: 92/42
- Other Building: 92/43
- Other Building: 92/44
- Other Building: 92/45
- Other Building: 92/46
- Other Building: 92/47
- Other Building: 92/48
- Other Building: 92/49
- Other Building: 92/50
- Other Building: 92/51
- Other Building: 92/52
- Other Building: 92/53
- Other Building: 92/54
- Other Building: 92/55
- Other Building: 92/56
- Other Building: 92/57
- Other Building: 92/58
- Other Building: 92/59
- Other Building: 92/60
- Other Building: 92/61
- Other Building: 92/62
- Other Building: 92/63
- Other Building: 92/64
- Other Building: 92/65
- Other Building: 92/66
- Other Building: 92/67
- Other Building: 92/68
- Other Building: 92/69
- Other Building: 92/70
- Other Building: 92/71
- Other Building: 92/72
- Other Building: 92/73
- Other Building: 92/74
- Other Building: 92/75
- Other Building: 92/76
- Other Building: 92/77
- Other Building: 92/78
- Other Building: 92/79
- Other Building: 92/80
- Other Building: 92/81
- Other Building: 92/82
- Other Building: 92/83
- Other Building: 92/84
- Other Building: 92/85
- Other Building: 92/86
- Other Building: 92/87
- Other Building: 92/88
- Other Building: 92/89
- Other Building: 92/90
- Other Building: 92/91
- Other Building: 92/92
- Other Building: 92/93
- Other Building: 92/94
- Other Building: 92/95
- Other Building: 92/96
- Other Building: 92/97
- Other Building: 92/98
- Other Building: 92/99
- Other Building: 92/100

Park Boženy Němcové(1:700), 25/28

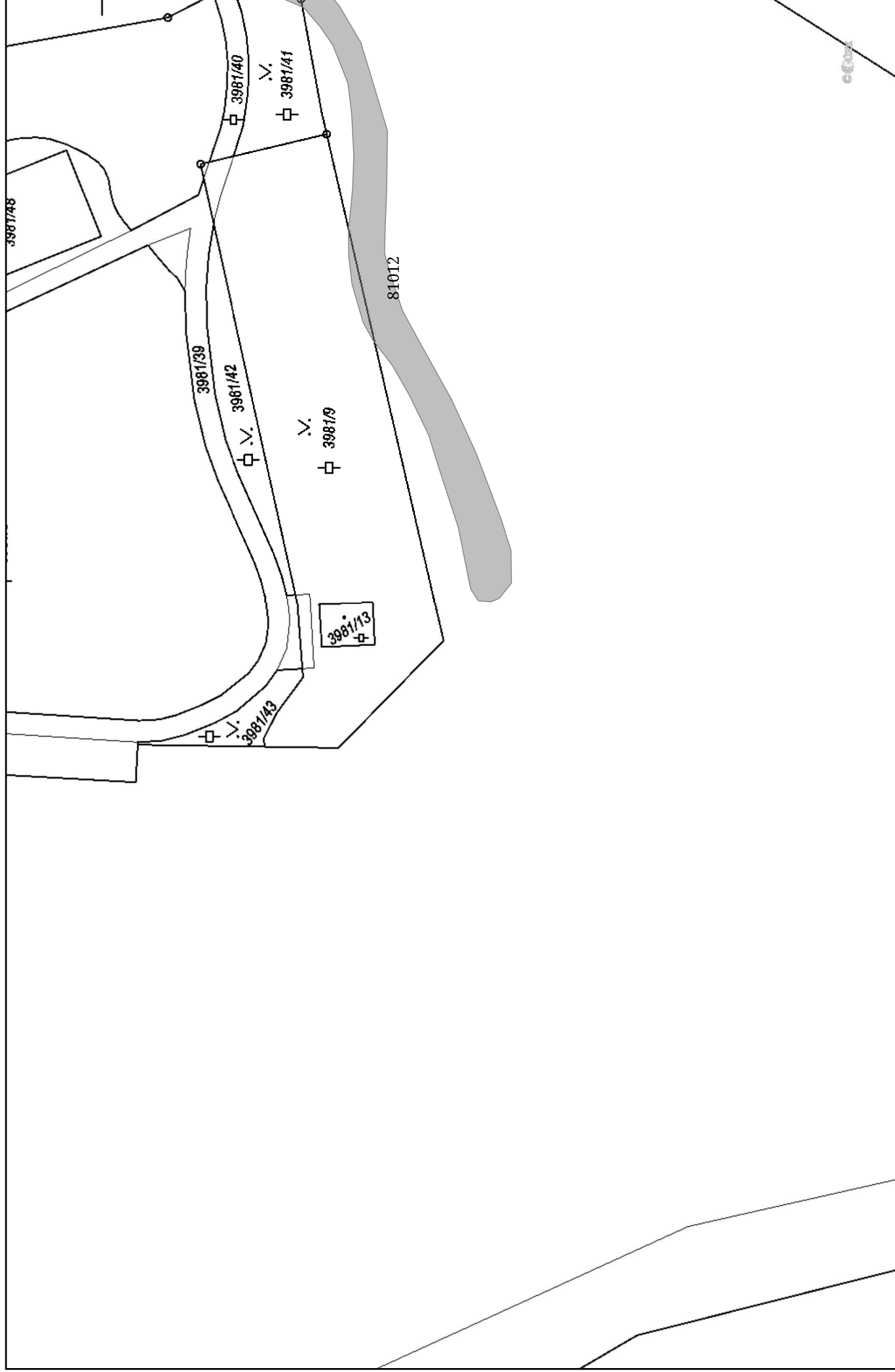

Park Boženy Němcové(1:700), 26/28

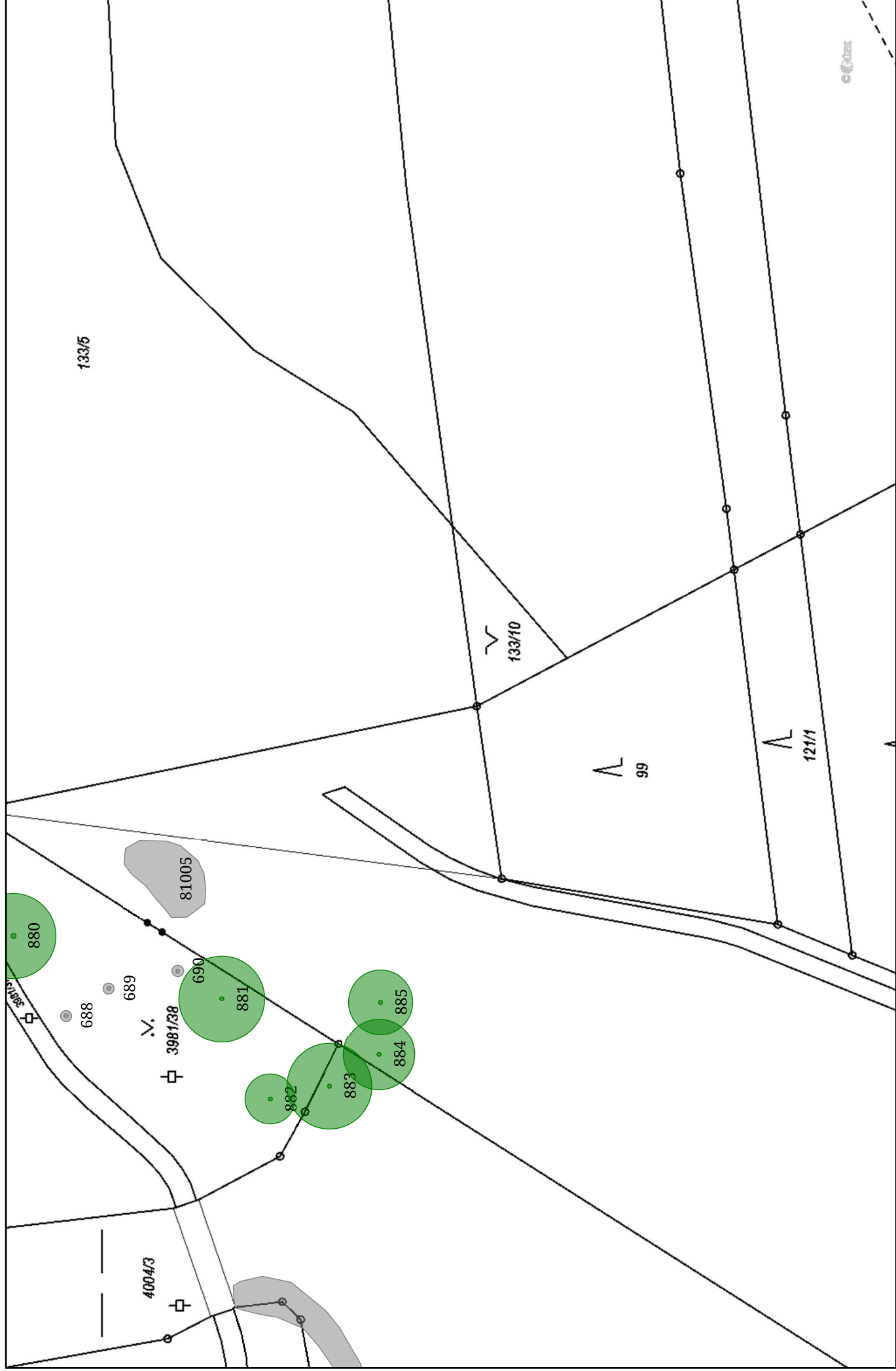

Park Boženy Němcové(1:700), 27/28

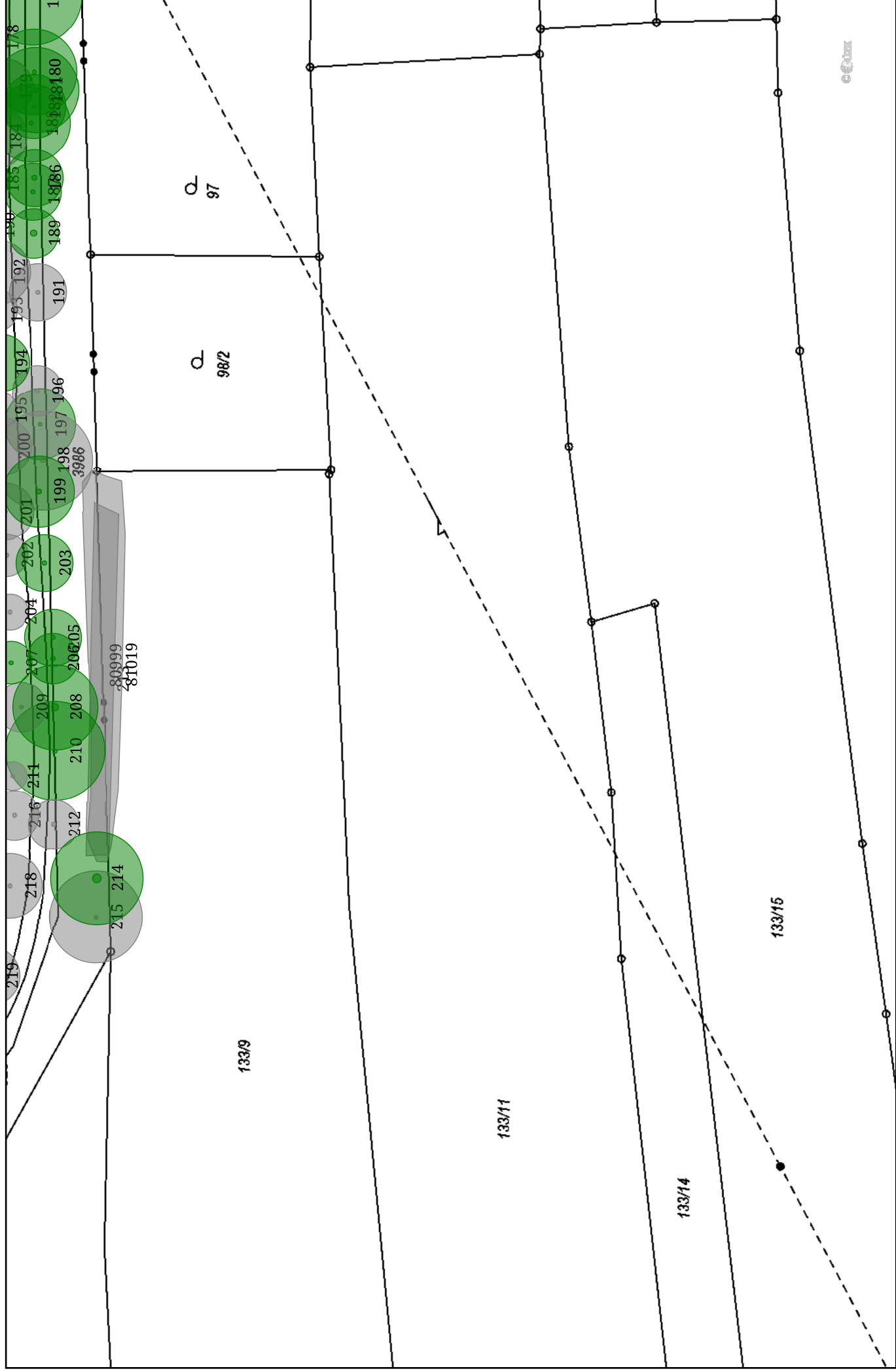

Parkoviště - před zámeckým parkem(1:700) - Klad listů (1:1487)



Parkoviště - před zámeckým parkem(1:700), 1/2



Parkoviště - před zámeckým parkem(1:700), 2/2



Poliklinika Karviná - Mizerov(1:700), 1/3

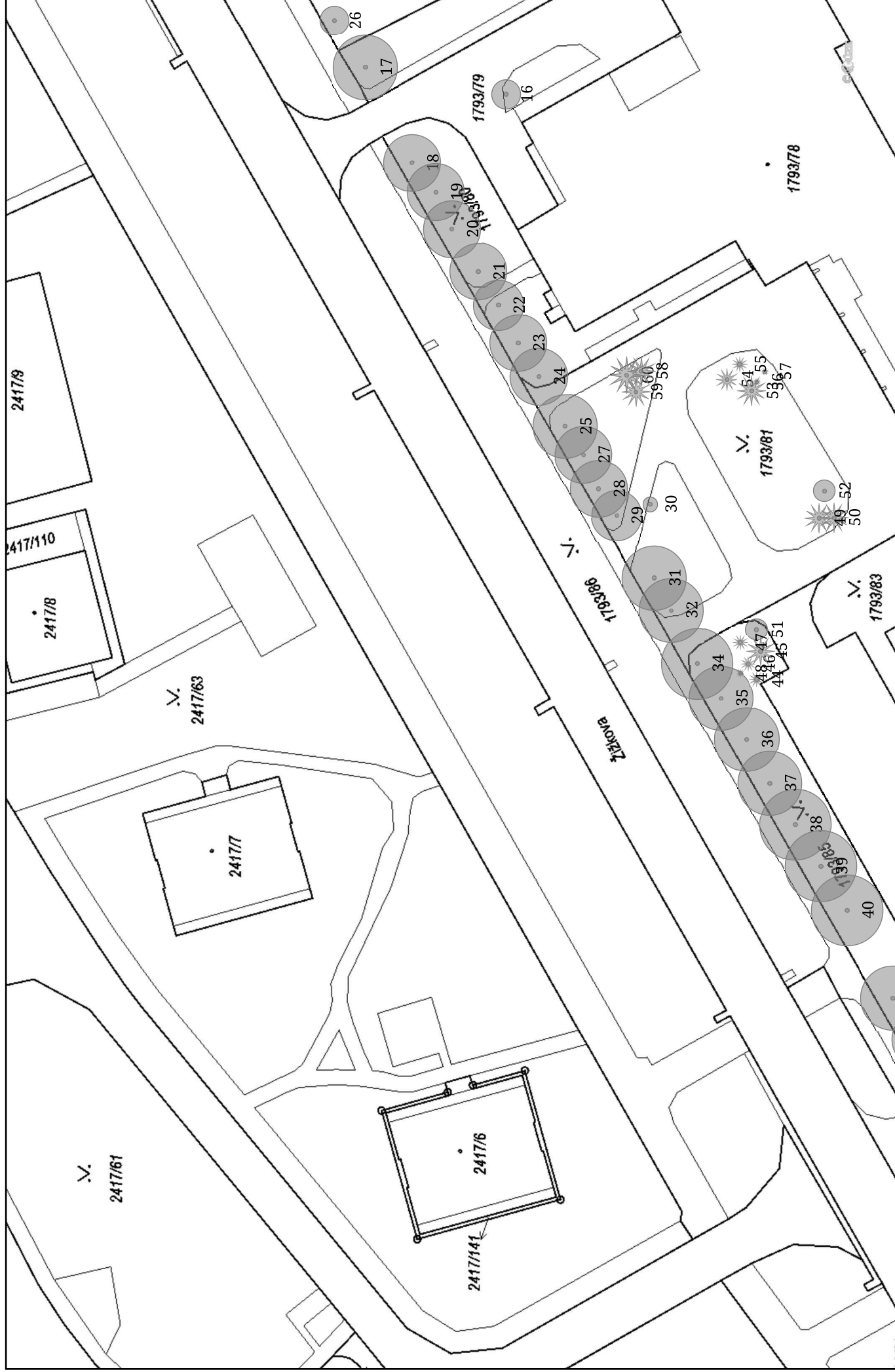

Poliklinika Karviná - Mizerov(1:700), 2/3

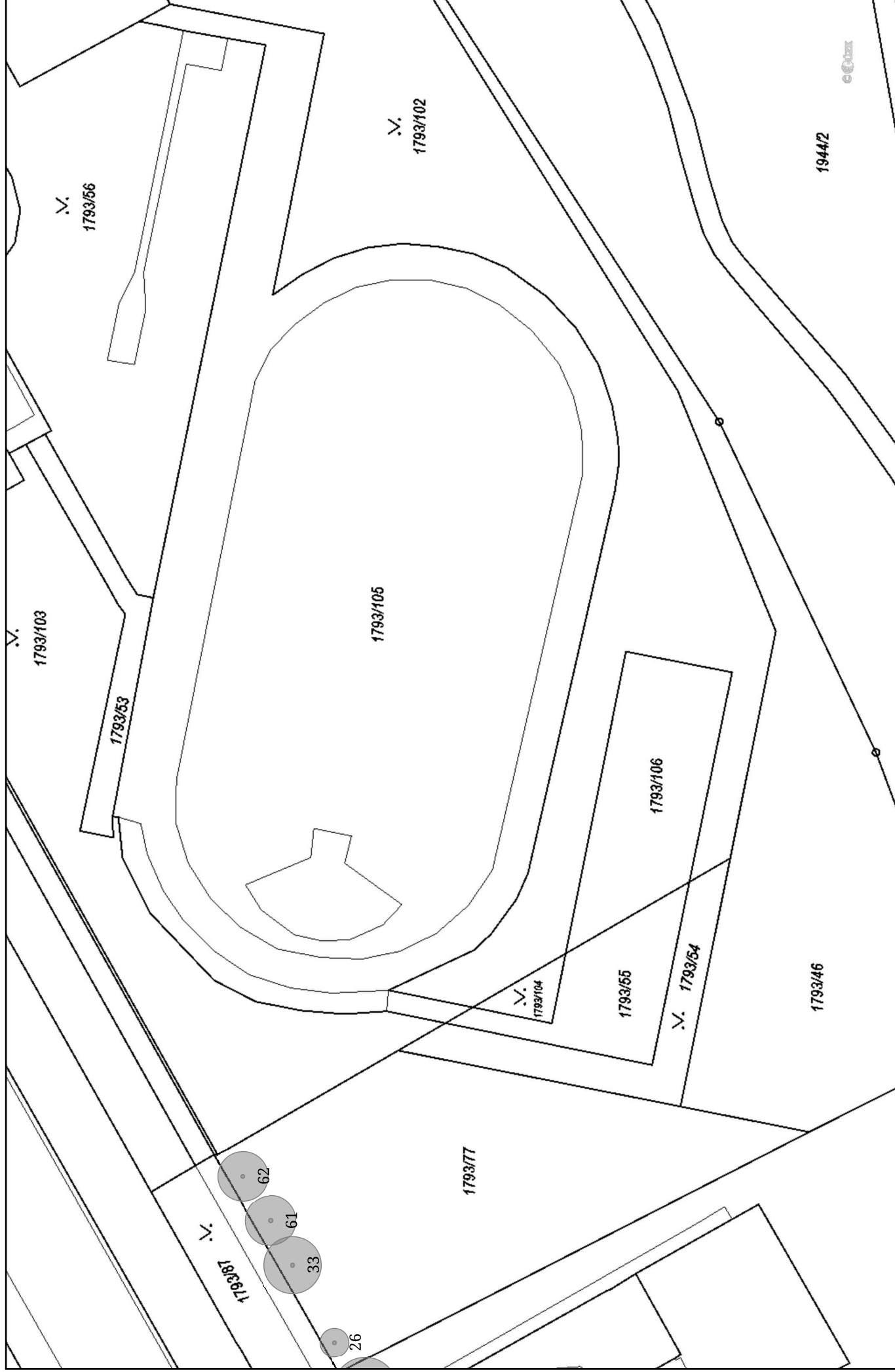

This map shows a residential area with several numbered plots. The plots are labeled with numbers 1 through 43. Plots 1 through 12 are highlighted in green, while plots 13 through 43 are highlighted in grey. The map also shows various roads and boundaries, including a road labeled '1793/1' and a road labeled '1793/19'. A road labeled '1793/83' is also visible. The map is oriented with North at the top.

Polská x Tř. 17. listopadu x Pokrok(1:700) - Klad listů (1:2975)

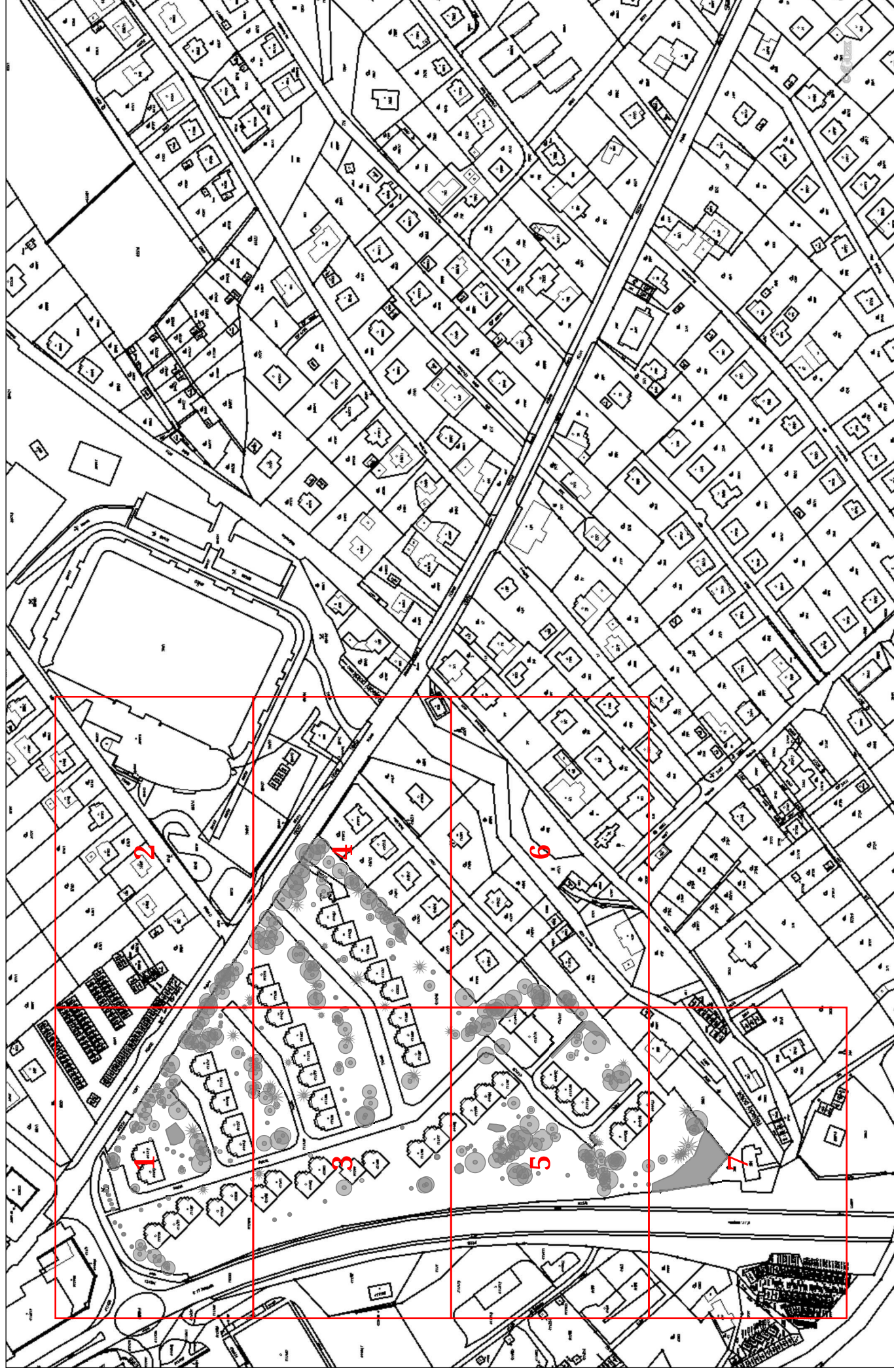

Polská x Tř. 17. listopadu x Pokrok(1:700), 2/7



Polská x Tř. 17. listopadu x Pokrok(1:700), 3/7



Polská x Tř. 17. listopadu x Pokrok(1:700), 4/7



Polská x Tř. 17. listopadu x Pokrok(1:700), 7/7

